

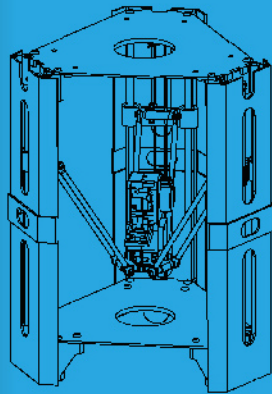

101 HERO

PYLON 3D PRINTER



Quick Start Guide

www.101HERO.com

101 HERO

THANKS FOR CHOOSING 101HERO PYLON 3D PRINTER!

Before starting the amazing crafting journey, it is strongly recommended for you go through this quick start guide. This will provide basic operation knowledge to help your 101HERO PYLON 3D printer working properly.





Cautions:

- 1 Do not touch the head of the Printer, it will in high temperature during operation.
- 2 Please be careful to avoid injury.
- 3 Do not leave the Printer unattended at run time.
- 4 Turn off the power to prevent injury when necessary.



PLEASE ENSURE THE FOLLOWINGS BEFORE START.

- 1 All components should be in good condition.
- 2 All items in packing list are included.

PACKING LIST:

Components you will need:

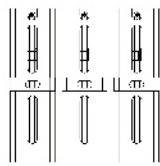

Stand Module Kit X 3

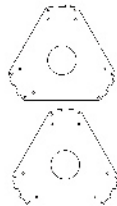

Cover Module X 2



Controller X 1



Extruder X 1



Power Adapter X 1



1.75mm PLA Filament X 1



Plate Tape X 1



Glass Plate X 1

1 ONE

ASSEMBLY MANUAL

1 Mounting three pieces of Stand Modules with one piece Bottom Cover Module.

Note:

(1) The Bottom Cover Module is same as the Top Cover Module

(2) During assembling, pay attention to the gap between Stand Modules and Bottom Cover modules. The wire should go through the gap and should not be overlaid by the Cover Module. (See #2)

Note:

The wire should go through the gap and should not be overlaid by the Cover Module.

(3) Mounting the screw of the Bottom Cover Module.

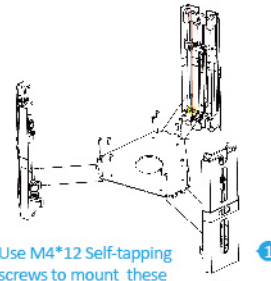

Use M4*12 Self-tapping screws to mount these parts, it need 12 screws in total.

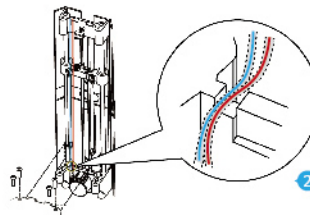

Note: the wire need to pass the gap.

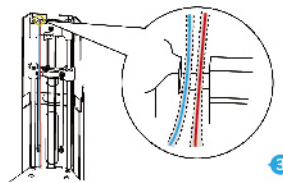

2 Mounting the Top Cover Module.

Note:

(1) Ensure the wire go through the gap and should not be overlaid by the Cover Module. (See #3.4.)

(2) Mounting the screw of the Top Cover Module.

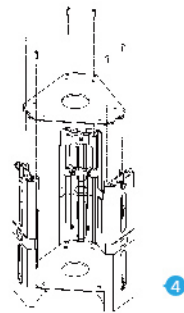

Use M4*12 Self-tapping screws to mount these parts, it need 6 screws in total.

3 Mounting the extruder with the 6 pieces of connected pods. And then mounting the screws at the edge of the extruder.

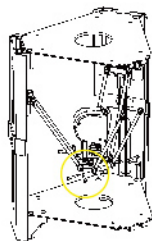

Before assembly

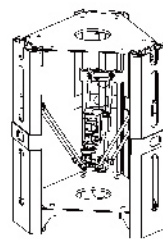

After assembly

Use M3*15 T-type Screws to mount these parts, it need 6 screws in total.

2 TWO

FEED THE FILAMENT:

1 Sharpen the end of 1.75mm PLA filament with scissors.

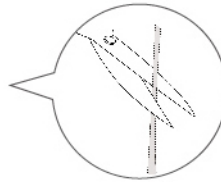

2 Open the gate of extruder and insert the filament into extruder tube. Pass the filament through extruding gear to go into the other part of extruder tube. Keep threading until it cannot be insert any more.

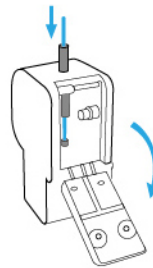

3 Shut the gate of extruder and mount the screws of it.

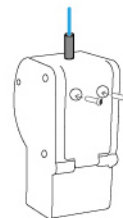

Use M3*8 Self-tapping Screws to mount these parts, it need 2 screws in total.

3 THREE

CONNECT THE CONTROLLER

1 Connect the connector to the controller. (See #5)

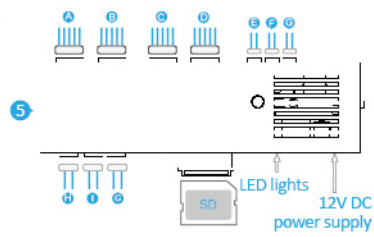

2 Plug in the DC 12V power adapter. (See #6.7)

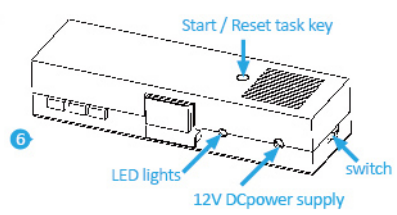

3 Turn the power switch on. (LED light will be lit up)

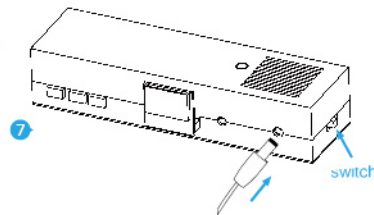

4 FOUR

CALIBRATION/LEVELLING

IN ORDER TO INCREASE THE VISCIDITY BETWEEN PLATE AND THE PRINT OBJECT, YOU NEED TO TAPE THE PRINTING AREA BEFORE PRINTER.

- 1 Open the tape and stick it on the glass plate across the centre, from one side to another side. Then shear off it.
- 2 Repeat the first step until the whole plate is covered with tape.
- 3 Then you need use hand or other things to make it smoothly.

NOTE:

Ensure the tapes are not folded with each other. You can leave gaps between them to avoid folding. Or it will cause unbalance of the printer.

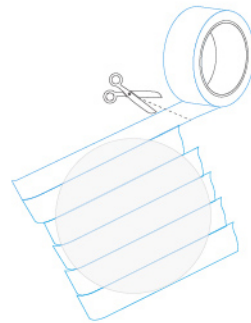

SD PRINTER TEST FILE CAN BE DOWNLOADED AT 101HERO.COM.
SAVE AND PRESS START
YOU CAN DOWNLOAD THE 3D PRINTER TEST FILE AT 101HERO.COM. BY SAVE AND PRESS START/RESET BUTTON, THE FILE
WILL START TESTING.

About 2 minutes later, the extruder will move up to touch the limit switch, then
move down to begin printing the model you saved just now.

NOTE :

1 If the filament cannot stick or patricianly stick on the platform, it means the
extruder is too far from the printing platform. You should loosen the relevant screw
of the stand module ANTICLOCKWISE, to reduce the distance between extruder and
platform.

2 If the filament is not being squeezed flattenedly, we also need to reduce the distance between the extruder and platform, even though the filament can stick perfectly.

3 If No filament is left on the tape when extruder pass by, it means the distance are too close. You should shut off the printer immediately and tighten the screw of the relevant stand module to increase the distance.

ATTENTION:

The filament will not instantly come out or practically come out when you start printing at the first time. It will work properly after several minutes.

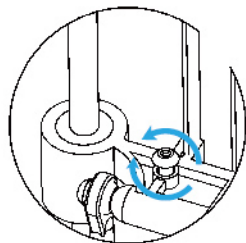

COUNTERCLOCKWISE:
Unscrew, nozzle and printing platform distance narrowing

CLOCKWISE:
Tighten, nozzle and printing platform distance increases

5 FIVE

PRINTS

IF YOU CHOOSE THE CUSTOM VERSION:

5.1.1 Go to 101land.com, choose a model you like then download it.

5.1.2 Save the model file in the SD card.

5.1.3 Insert the SD card into 101HERO PYLON 3D Printer controller slot.

5.1.4 Switch on the controller and press the reset button on the top of the controller.

5.1.5 When printing is completed, you need to wait until the extruder move to the top of the printer. And after 5 minutes, the extruder will cool down to the room temperature. Then you can remove the printer object by using a knife or similar tools.



IF YOU CHOOSE THE DESIGNER VERSION:

5.2.1 You can also download a 3D model from the website, please refer to the steps of 5.1.1 to 5.1.5.

5.2.2 If you want to design your own model, please download or create a 3D model file. (Usually are .stl or .obj file)

5.2.3 Import the file into slice software and generate a gcode file. Please rename the file to "101HERO".

5.2.4 Connect the 101HERO PYLON 3D Printer and PC, Mac or even Raspberry Pi with the USB cable. Start the host control software such as Pronterface, Repetier-Host and Cura, and then wait for PC or Mac to identify the 101HERO 3D Printer. Or you save the file into SD card directly.

5.2.5 Use the control software to load the model file then start printing. Or insert the SD card to the 101HERO PYLON 3D Printer controller slot to start printing.

For the following steps, please refer to [5.1.4](#) and [5.1.5](#).

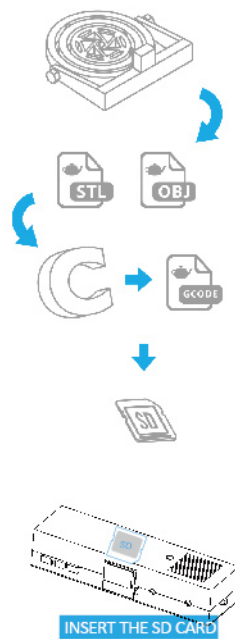

101 HERO

WELL DONE!

You have already completed the quick start guide.
For more advanced skills,
please visit: www.101HERO.com.

HAPPY PRINTING.

